

HYTORC AVANTI HYDRAULIC TORQUE WRENCH

HYTORC AVANTI takes counterforce from the drive axle, similar to the ICE model, reducing lateral load and stress on the wrench. This improves torque accuracy and durability.

- | Counterforce taken from the drive axle.
- | Easy tool positioning with a 360° x 180° swiveling connector assembly.
- | Compatible with Washer and J-Washer washers and NUT mounting elements.
- | Designed for industrial production and maintenance use.
- | Includes recoil-preventing counterforce latch.
- | Wide size range covering 155 Nm – 190,000 Nm.
- | Includes calibration certificate.
- | Includes removable support handle (not included in AVANTI-.7).
- | Delivered in a carrying case.

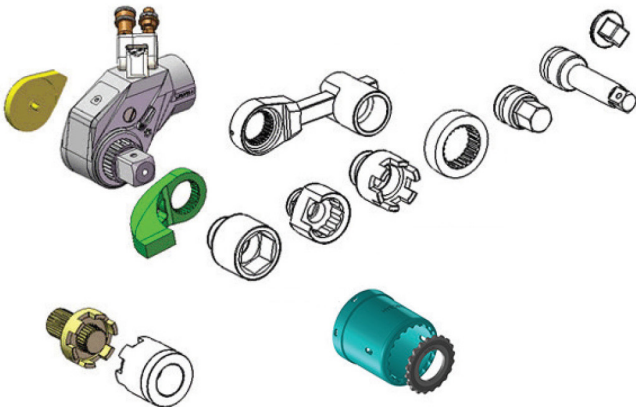

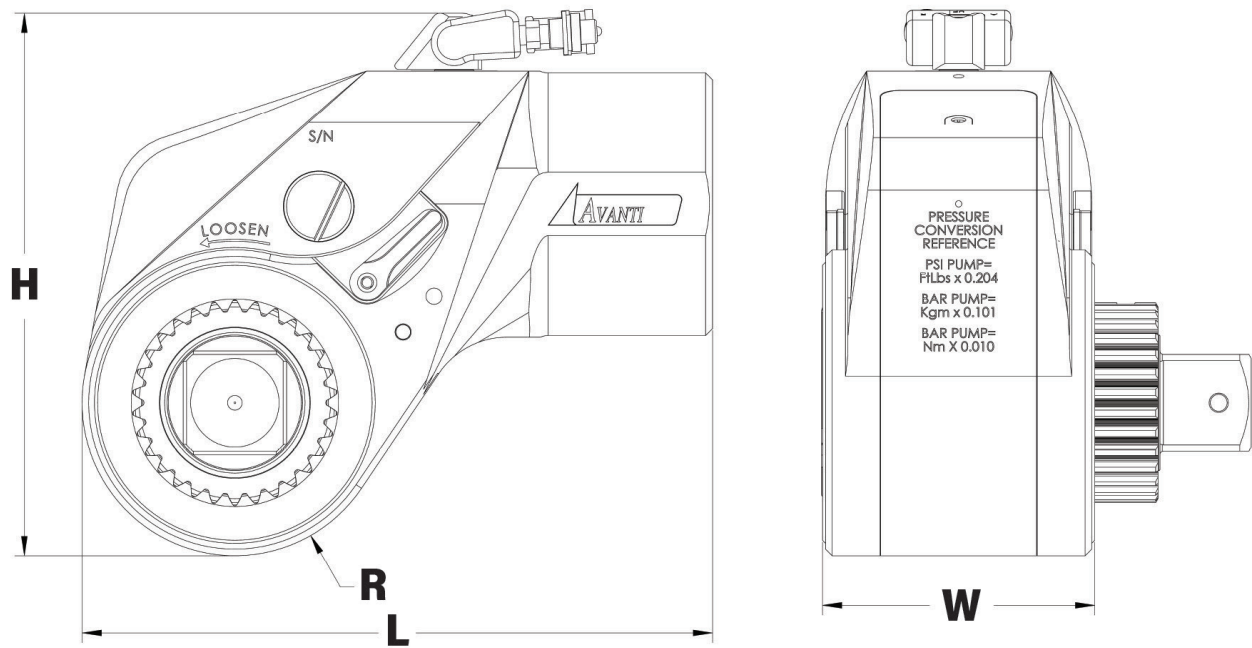

MODELS AND DIMENSIONS

Item	Drive	Torque range Nm	R mm	L mm	H mm	W mm	Weight kg
AVANTI-7	3/4"	156 - 1 039	25	105	106	45	1,4
AVANTI-8	1 1/2"	1 558 - 10 515	49	209	201	98	9,4
AVANTI-20	2 1/2"	3 740 - 24 241	66	278	260	129	21,7
AVANTI-35	2 1/2"	6 646 - 43 130	81	342	310	158	37,6
AVANTI-50	2 1/2"	9 759 - 62 501	100	395	353	179	58,1
AVANTI-80	3 1/2"	16 213 - 116 118	119	496	428	190	127,5
AVANTI-130	3 1/2"	26 280 - 187 683	135	577	493	216	265,9

REDUCED LATERAL LOAD



The counterforce support aligned with the drive axle reduces lateral load and stress on the wrench. This ensures a longer lifespan and improved torque accuracy.

TORQUE AND ANGLE DIAL



Users get a clear angle reading for each application during all bolting sessions that incorporate turn-of-the-nut.

MULTI-USE SYSTEMS



AVANTI works with conventional bolting equipment as well as the HYTORC Nut and HYTORC Washer, making bolting applications safer, faster, and more accurate.

ACCESSORIES

HYDRAULIC TORQUE WRENCHES

REACTION ARMS AND SOLUTIONS



1



2



3



4



5



6



7



8



9



10



11



12

Number	Description	Compatibility
1	Square drive type reaction arm	MXT+ / ICE / AVANTI
2	360° x 360° rotatable reaction arm	MXT+ / ICE / AVANTI
3	Standard reaction arm	MXT+ / MXT / EDGE-S
4	Reaction sleeve	MXT+ / MXT / EDGE-S
5	Track pad fixture	MXT+ / ICE / AVANTI
6	Washer driver socket	MXT+ / ICE / AVANTI
7	HYTORC Nut driver	MXT+ / ICE / AVANTI
8	Alco arm	MXT+ / MXT / EDGE-S
9	U-shaped reaction arm	MXT+ / ICE / AVANTI
10	Reaction pad	STEALTH / VERSA / XLCT
11	Alco arm	STEALTH / VERSA / XLCT
12	Welding adapter	MXT+ / ICE / AVANTI

DUAL HYDRAULIC HOSES

- Hose working pressure: 700 bar
- High-visibility color ensures visibility even in poor conditions
- Hose lengths can be customized according to customer specifications, starting from 0.5 m
- All hoses, wrenches, and pumps can be equipped with connectors according to customer requirements
- Standard lengths (m): 5, 6, 8, 10, 12, 16
- Available with protective casing

