

HIILIKUITUISET TELESKOOPPIVARRET (CARBO-ARM)

Hiilikuituiset vastamomenttivarret ovat suosittuja tukivarsivaihtoehtoja niiden helpon asennettavuuden, vähäisen tilantarpeen ja kustannustehokkuuden vuoksi. Asennuksessa tulee huomioida, että vastamomenttivarret absorboivat momentin 90°:n kulmassa suhteessa niiden omaan akseliin.

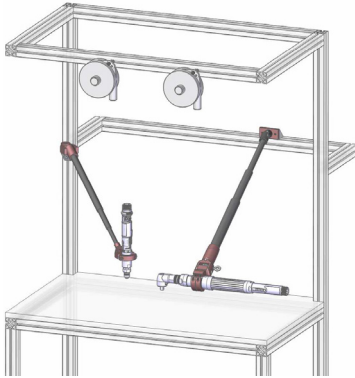

Pystysuora kiristysakseli

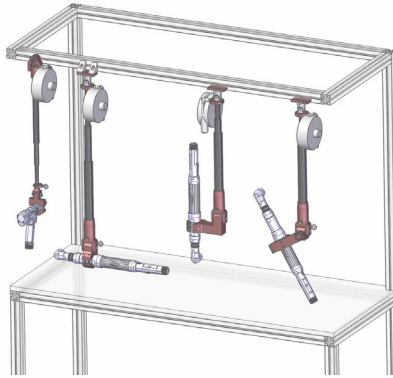

Vaakasuuora kiristysakseli

| Momenttivarvi | Max. momentti Nm | Vakio-pidin | Työkalu Ø mm | Min. pituus mm | Max. pituus mm | Nimike ilman pidintä | Vakiopitimitellä |
|-----------------------------|------------------|-------------|--------------|----------------|----------------|----------------------|------------------|
| Vakioiskunpituudet | | | | | | | |
| DMF 5/950 | 5 | P1 | 25 - 42 | 460 | 950 | - | 4-5300445 |
| DMF 12/950 | 12 | P1 | 27 - 50 | 460 | 950 | - | 4-5301004 |
| DMF 12/1500 | 12 | P1 | 27 - 50 | 650 | 1 500 | - | 4-5301005 |
| DMF 12/2000 | 12 | P1 | 27 - 50 | 820 | 2 000 | - | 4-5301006 |
| DMF 30/960 | 30 | P1 | 28 - 52 | 475 | 960 | 4-5344000 | 4-5300074 |
| DMF 30/1500 | 30 | P1 | 28 - 52 | 656 | 1 500 | 4-5344001 | 4-5300282 |
| DMF 30/2000 | 30 | P1 | 28 - 52 | 823 | 2 000 | 4-5344002 | 4-5300283 |
| DMF 30/2500 | 30 | P1 | 28 - 52 | 993 | 2 500 | 4-5344003 | 4-5300284 |
| DMF 30/3000 | 30 | P1 | 28 - 52 | 1 321 | 3 000 | 4-5300813 | 4-5300818 |
| DMFi 70/1500 | 70 | P2 | 35 - 52 | 667 | 1 500 | 4-5344004 | 4-5344020 |
| DMFi 70/2000 | 70 | P2 | 35 - 52 | 833 | 2 000 | 4-5344005 | 4-5344021 |
| DMFi 70/2500 | 70 | P2 | 35 - 52 | 1 000 | 2 500 | 4-5344006 | 4-5344022 |
| DMFi 70/3000 | 70 | P2 | 35 - 52 | 1 330 | 3 000 | 4-5300814 | 4-5300819 |
| DMFi 120/1500 | 120 | P2 | 35 - 52 | 691 | 1 500 | 4-5344007 | 4-5344023 |
| DMFi 120/2000 | 120 | P2 | 35 - 52 | 857 | 2 000 | 4-5344008 | 4-5344024 |
| DMFi 120/2500 | 120 | P2 | 35 - 52 | 1 023 | 2 500 | 4-5344009 | 4-5344025 |
| DMFi 120/3000 | 120 | P2 | 35 - 52 | 1 347 | 3 000 | 4-5300815 | 4-5300820 |
| DMFi 200/1500 | 200 | P2 | Max 63 | 920 | 1 500 | 4-5344050 | 4-5344026 |
| DMFi 200/2000 | 200 | P2 | Max 63 | 1 170 | 2 000 | 4-5344051 | 4-5344027 |
| DMFi 200/2500 | 200 | P2 | Max 63 | 1 420 | 2 500 | 4-5344052 | 4-5344028 |
| DMFi 200/3000 | 200 | P2 | Max 63 | 1 720 | 3 000 | 4-5300816 | 4-5300821 |
| DMFi 300/1500 | 300 | P2 | Max 73 | 970 | 1 500 | 4-5344053 | 4-5344029 |
| DMFi 300/2000 | 300 | P2 | Max 73 | 1 220 | 2 000 | 4-5344054 | 4-5344030 |
| DMFi 300/2500 | 300 | P2 | Max 73 | 1 470 | 2 500 | 4-5344055 | 4-5344031 |
| DMFi 300/3000 | 300 | P2 | Max 73 | 1 800 | 3 000 | 4-5300817 | 4-5300822 |
| Pitkäiskuiset mallit | | | | | | | |
| DMF 30/1500 LS | 30 | P1 | 28 - 52 | 555 | 1 500 | 4-5300852 | 4-5300855 |
| DMF 30/2000 LS | 30 | P1 | 28 - 52 | 680 | 2 000 | 4-5300853 | 4-5300856 |
| DMF 30/2500 LS | 30 | P1 | 28 - 52 | 805 | 2 500 | 4-5300854 | 4-5300857 |
| DMFi 100/1500 LS | 100 | P2 | 35 - 52 | 592 | 1 500 | 4-5301213 | 4-5301221 |
| DMFi 100/2000 LS | 100 | P2 | 35 - 52 | 717 | 2 000 | 4-5301214 | 4-5301222 |
| DMFi 100/2500 LS | 100 | P2 | 35 - 52 | 842 | 2 500 | 4-5301215 | 4-5301223 |
| DMFi 200/1500 LS | 200 | P2 | Max 63 | 728 | 1 500 | 4-5301216 | 4-5301224 |
| DMFi 200/2000 LS | 200 | P2 | Max 63 | 894 | 2 000 | 4-5301217 | 4-5301225 |
| DMFi 200/2500 LS | 200 | P2 | Max 63 | 1 060 | 2 500 | 4-5301220 | 4-5301226 |

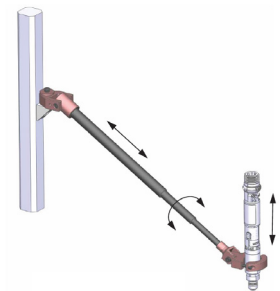

Pystysuora kiristysakseli

HIILIKUITUVARSIENTYÖKALUPITIMET JA LISÄVARUSTEET

| Momenttivarrelle | Työkalu Ø | Nimike |
|----------------------------------|-------------------|-----------|
| P1-työkäluopin | | |
| DMF12 | Pidin 27/50 | Standardi |
| DMF30 | Pidin 28/52 | Standardi |
| DMFi70 | Adapterikiinnitys | 4-5344032 |
| DMFi120 | Adapterikiinnitys | 4-5344033 |
| DMFi200 | Adapterikiinnitys | 4-5344061 |
| DMF300 | Adapterikiinnitys | Kysy |
| P2-työkäluopin | | |
| DMF30 | 28/52 | 4-5200300 |
| DMFi70 | 35/52 | Standardi |
| DMFi120 | 35/52 | Standardi |
| DMFi200 | Max 63 | Standardi |
| DMF300 | Max 73 | Standardi |
| P3-työkäluopin | | |
| DMF30 | 28/52 | 4-5200301 |
| DMFi70 | 35/52 | 4-5344013 |
| DMFi120 | 35/52 | 4-5244014 |
| DMFi200 | 35/52 | 4-5344066 |
| DMFi200 | Max 63 | 4-5344056 |
| DMF300 | Max 73 | 4-5244057 |
| P4-työkäluopin | | |
| DMF30 | 28/52 | 4-5200302 |
| DMFi70 | 35/52 | 4-5344015 |
| DMFi120/200 | 35/52 | 4-5244016 |
| DMFi200 | Max 63 | 4-5344058 |
| DMF300 | Max 73 | 4-5244059 |
| Käännettävä työkaluliitin | | |
| DMFi70 P2/P4 | 35/52 | 4-5301137 |
| DMFi120/200 P2/P4 | 35/52 | 4-5201138 |
| DMFi200 P2/P4 | Max 63 | 4-5301139 |
| DMF300 | Max 73 | Kysy |
| Kierrettävä pidin | | |
| DMF30 | Max 43 | 4-5201134 |
| DMFi70 | Max 45 | 4-5344068 |
| DMFi70 | 45/50 | 4-5344034 |
| DMFi120/100 LS | Max 45 | 4-5344067 |
| DMFi120/100 LS | 45/50 | 4-5244035 |
| DMFi200/200 LS | Max 58 | 4-5344060 |
| DMF300 | Max 70 | 4-5201136 |

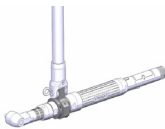
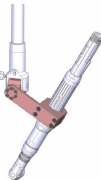
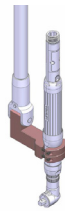
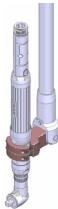
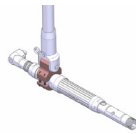
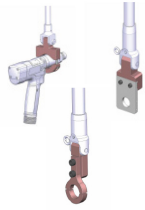

KALLISTUSADAPTERI

| Momenttivarrelle | 15° | 30° |
|------------------------|-----------|-----------|
| DMF30 (kaikki pitimet) | 4-5283168 | 4-5283169 |

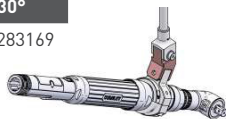

TYÖKÄLUPIDIN PIKALUKITUKSELLA

| Momenttivarsi | Pitimelle | Adapteri | Nimike |
|---------------|-----------|-----------|-----------|
| DMF12 | P1 | 4-5200470 | 4-5201003 |
| DMF30 | P1 | 4-5200471 | 4-5200017 |
| DMFi70 | P2 | 4-5383100 | 4-5283102 |
| DMFi120 | P2 | 4-5283101 | 4-5283103 |
| DMFi200 | P2 | 4-5344063 | 4-5344062 |

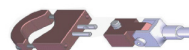

HIILIKUITUVARSIENTYÖKÄLÖJÄRJESTELMÄ JA KEVENTIMET

KISKOT

| Kokonaispituus | Hyöty-pituus | Kiinnityspisteet | Nimike |
|----------------|--------------|------------------|-----------|
| 600 | 450 | 2 | 4-5200132 |
| 800 | 650 | 2 | 4-5200160 |
| 1 000 | 850 | 2 | 4-5200161 |
| 1 200 | 1050 | 3 | 4-5200162 |
| 1 500 | 1350 | 3 | 4-5200163 |
| 2 000 | 1850 | 4 | 4-5200164 |

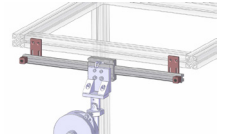

| Momenttivarsi | Tyyppi | Nimike |
|---|--------|-----------|
| Carbo-armin kiinnittäminen kissaan | | |
| DMF12/30 | | 4-5200341 |
| DMFi70/120/200 | | 4-5200708 |
| DMF300 | | 4-5300342 |

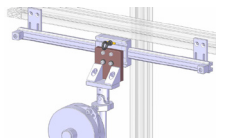

| Momenttivarsi | Tyyppi | Nimike |
|-----------------------------|---------------|-----------|
| Pneumaattiset jarrut | | |
| DMF12/30 | Pneumaattinen | 4-5200442 |
| DMF12/30 | Sähköinen | 4-5200869 |
| DMFi70/120 | Pneumaattinen | 4-5200706 |
| DMFi70/120 | Sähköinen | 4-5200707 |
| DMFi200 | Sähköinen | 4-5201150 |
| DMFi300 | Sähköinen | 4-5301142 |

| Momenttivarsi | Nimike |
|---|-----------|
| Muut kiskojärjestelmän varusteet | |
| Vaimentava päätykappale | 4-5201121 |
| Sivusuuntainen stoppari 8/20/50 | 4-5200167 |
| Sivuttainen stoppari 150/300 | 4-5283201 |
| Lisäkiinnityspiste | 4-5200873 |
| Kiskojen jatkokappale | 4-5200307 |
| Lisäkissa toiselle varrelle | 4-5200165 |
| Lisäkissa toiselle keventimelle | 4-5200166 |
| Keventimen kiinnityspiste | 4-5200309 |

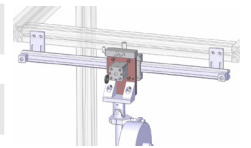

CARBO-ARMIEN KEVENTIMET

| Momenttivarsi | Kapasiteetti (kg) | Nimike |
|----------------|-------------------|-----------|
| DMF12 | 1 - 2 | 4-5200303 |
| DMF30 | 1 - 2,5 | 4-5200304 |
| DMF30 | 2 - 4 | 4-5200305 |
| DMF300 | 4 - 8 | 4-5344064 |
| DMF300 | 6 - 10 | 4-5344065 |
| DMFi70/120/200 | 2 - 4 | 4-5200701 |
| DMFi70/120/200 | 4 - 6 | 4-5200702 |
| DMFi70/120/200 | 6 - 8 | 4-5200703 |

